

## → Mitre-joint connectors with joint

### Note

The **inset distances F** in mm in the table apply to mitre-joint connectors with **drilling dim. B 44 mm**.

For **drilling dim. B 24 mm**, 20 mm must be deducted from the specified **inset distances F**.

The dimension for **drilling depth D** corresponds to drilling depth D of the Minifix connector housing that is used.

Please use connector housing **without rim**.

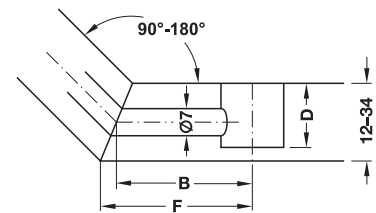
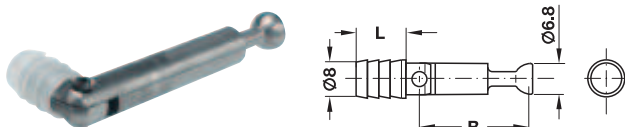

Table for inset distance F in mm

Mitre angle	Wood thickness mm														
	12	13	15	16	17	18	19	20	22	23	25	26	29	32	34
90°	50.0	50.5	51.0	52.0	52.5	53.0	53.5	54.0	55.0	55.5	56.0	57.0	58.5	60.0	61.0
100°	49.0	49.5	50.3	50.7	51.1	51.5	52.0	52.4	53.2	53.6	54.0	54.9	56.2	57.4	58.3
110°	48.2	48.6	49.2	49.6	50.0	50.4	50.7	51.0	51.7	52.1	52.5	53.1	54.2	55.2	56.0
120°	47.5	47.8	48.3	48.6	48.9	49.2	49.5	49.8	50.4	50.6	50.8	51.5	52.4	53.2	53.8
130°	46.8	47.0	47.4	47.7	48.0	48.3	48.4	48.7	49.1	49.4	49.7	50.1	50.8	51.5	51.9
135°	46.5	46.7	47.1	47.3	47.5	47.7	47.9	48.1	48.6	48.8	49.0	49.4	50.0	50.6	51.1
140°	46.2	46.4	46.7	46.9	47.1	47.3	47.5	47.6	48.0	48.2	48.6	48.8	49.3	49.8	50.2
150°	45.6	45.7	46.0	46.1	46.2	46.3	46.5	46.7	46.9	47.1	47.3	47.5	47.9	48.3	48.6
160°	45.0	45.1	45.3	45.4	45.5	45.6	45.7	45.8	45.9	46.0	46.1	46.3	46.6	46.8	47.0
170°	44.5	44.6	44.6	44.7	44.7	44.8	44.8	44.9	44.0	45.0	45.1	45.2	45.3	45.4	45.5
180°	44.0	44.0	44.0	44.0	44.0	44.0	44.0	44.0	44.0	44.0	44.0	44.0	44.0	44.0	44.0

### For one-sided installation, with polyamide sleeve



- > Area of application: For mitre angles from 90° to 180°
- > Thread: Polyamide sleeve with harpoon-type thread
- > Bolt hole: 7 mm

Thread length L mm	Drilling dim. B mm	Packing pieces	Galvanized
11	24	100 or 1000	262.12.822
	44	100 or 500	262.12.804

### For one-sided installation, with M6 thread

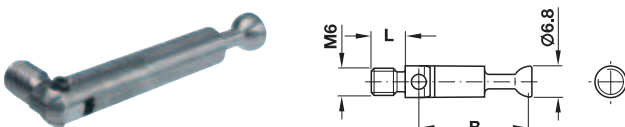

- > Area of application: For mitre angles from 90° to 180°
- > Thread: M6
- > Bolt hole: 7 mm

Thread length L mm	Drilling dim. B mm	Packing pieces	Galvanized
7.5	24	1000	262.12.840
	44	500	262.12.984

Packing: 100 or 500 pieces

### For double-sided installation, double-ended bolt

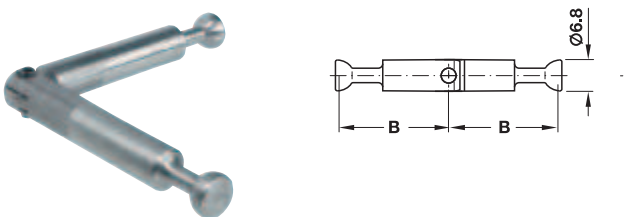

- > Area of application: For mitre angles from 90° to 180°
- > Bolt hole: 7 mm

Drilling dim. B mm	Galvanized
24	262.12.859
44	262.12.939

Packing: 100 or 500 pieces